

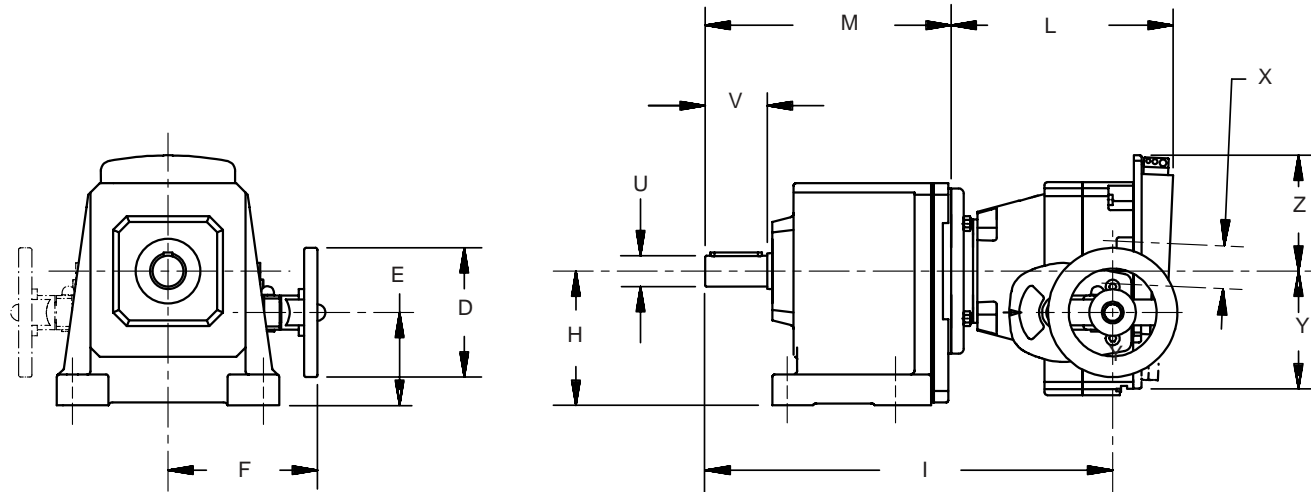

# "C" Series – MGS® Adjustable Speed Drives Dimensional Data



Drawing for Units  
C002N — C503N

Table No. 1

"C" Series – "N" Housing Style  
Dimensions (Inches)

Base Module	H	U	V
<b>C002</b>	3.23	.7500	1.57
<b>C102</b>	4.02	1.0000	1.97
<b>C202/C203</b>	4.53	1.2500	2.36
<b>C302/C303</b>	5.12 <sup>(1)</sup>	1.2500	2.36
<b>C402/C403</b>	5.71	1.6250	3.15
<b>C502/C503</b>	6.69	1.6250	3.15
<b>C612/C613</b>	7.87	2.1250	3.94
<b>C712/C713</b>	9.25	2.3750	4.72
<b>C812/C813</b>	11.42	2.8750	5.51
<b>C912/C913</b>	13.39	3.6250	6.69

<sup>(1)</sup> "H" dimension on the input side of a C303 with an TD27 and TD37 will be 3.66.

Table No. 2

"C" Series Foot Mounting Unit Dimensions (Inches) – "N" Housing Style

ComTrac Part No.	NEMA C-Flange	D	F	L	X	Y	Z
<b>TD270K050</b>	56C	4.92	5.67	7.87	2.09	5.55	4.41
<b>TD270K140</b>	143/145TC	4.92	5.67	7.87	2.09	5.55	4.41
<b>TD370K140</b>	143/145TC	4.92	5.91	8.50	2.17	5.67	4.37
<b>TD470K180</b>	182/184TC	6.30	6.81	8.94	2.80	7.20	5.59
<b>TD570K180</b>	182/184TC	7.87	8.31	11.89	3.11	8.11	6.30
<b>TD670K210</b>	213/215TC	7.87	9.17	12.17	3.86	9.02	7.13
<b>TD760K210</b>	213/215TC	9.84	9.72	14.25	4.29	9.37	7.68

Table No. 3

"C" Series Foot Mounting – "N" Housing Style – Approximate Weight (lbs.)

Part Number	C002	C102	C202	C203	C302	C303	C402	C403	C502	C503	C612	C613	C712	C713	C812	C813	C912	C913
<b>TD270K050<sup>(2)</sup></b>	51	62	71	78	82	89	—	111	128	144	—	148	—	—	—	—	—	—
<b>TD370K140</b>	69	80	89	—	100	—	122	129	146	162	—	210	—	—	—	—	—	—
<b>TD470K180</b>	—	88	97	—	108	—	130	—	154	—	174	218	—	280	—	401	—	—
<b>TD570K180</b>	—	—	126	—	137	—	159	—	183	—	203	247	287	309	—	430	—	—
<b>TD670K210</b>	—	—	—	—	179	—	201	—	225	—	245	—	329	—	452	472	—	808
<b>TD760K210</b>	—	—	—	—	—	—	—	—	289	—	309	—	393	—	516	—	790	—

<sup>(2)</sup> Also available as TD270K140 for a NEMA 143TC frame motor.

See the MGS catalog for dimensions not shown.

# "C" Series – MGS® Adjustable Speed Drives Dimensional Data

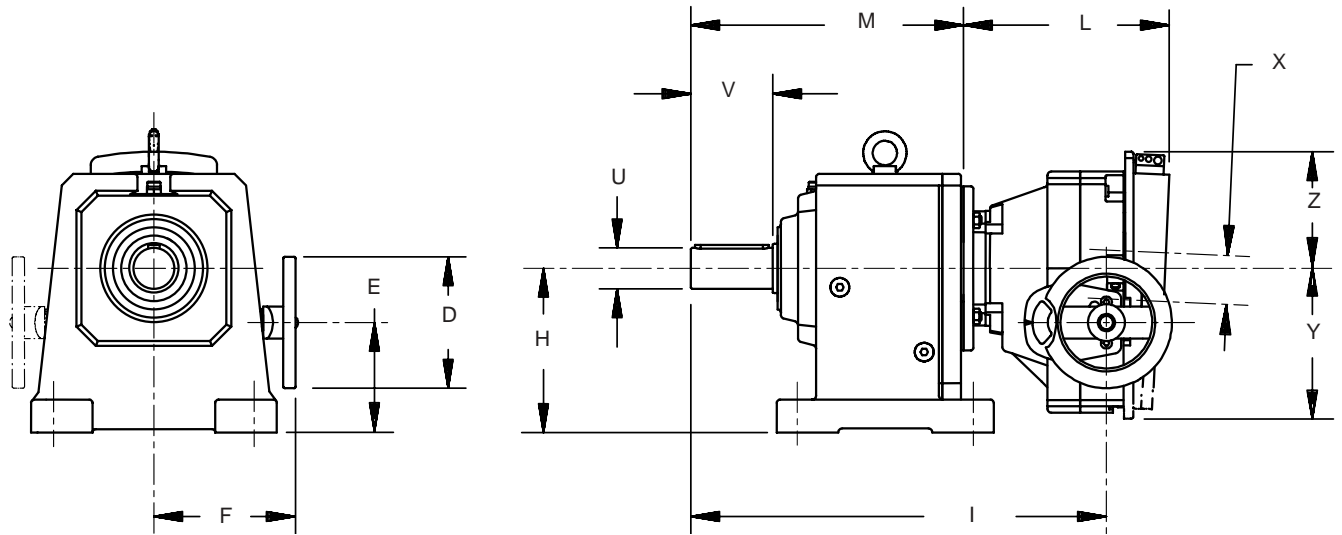

Drawing for Units  
C612N — C913N

Table No. 4 "C" Series – Foot Mounting Unit Dimensions (Inches) – "N" Housing Style

Base Module	TD270K050 <sup>(2)</sup>			TD370K140			TD470K180			TD570K180			TD670K210			TD760K210		
	E	I	M	E	I	M	E	I	M	E	I	M	E	I	M	E	I	M
C002	1.65	12.40	6.22	1.18	13.07	6.22	—	—	—	—	—	—	—	—	—	—	—	—
C102	2.44	13.70	7.52	1.97	14.37	7.52	1.42	14.49	7.60	—	—	—	—	—	—	—	—	—
C202	2.95	14.80	8.62	2.48	15.47	8.62	1.93	15.59	8.70	1.18	18.23	8.70	—	—	—	—	—	—
C203	2.01	16.50	10.31	—	—	—	—	—	—	—	—	—	—	—	—	—	—	—
C302	2.80	15.55	9.37	2.56	16.22	9.37	1.65	16.34	9.45	.16	18.98	9.45	-.71	19.29	9.57	—	—	—
C303 <sup>(1)</sup>	2.09	17.24	11.06	—	—	—	—	—	—	—	—	—	—	—	—	—	—	—
C402	—	—	—	3.66	18.11	11.26	3.11	18.23	11.34	2.36	20.87	11.34	2.17	21.18	11.46	—	—	—
C403	4.13	19.13	12.95	3.66	19.80	12.95	—	—	—	—	—	—	—	—	—	—	—	—
C502	—	—	—	4.65	18.94	12.09	4.09	19.06	12.17	3.35	21.69	12.17	3.15	22.01	12.28	3.15	24.45	12.83
C503	5.12	19.96	13.78	4.65	20.63	13.78	—	—	—	—	—	—	—	—	—	—	—	—
C612	—	—	—	—	—	—	5.28	20.00	13.11	4.53	22.64	13.11	4.33	22.95	13.23	4.33	25.35	13.74
C613	6.30	20.94	14.76	5.83	21.61	14.76	5.28	22.44	15.55	4.53	25.08	15.55	—	—	—	—	—	—
C712	—	—	—	—	—	—	—	—	—	5.91	24.72	15.20	5.71	25.00	15.28	5.71	27.40	15.79
C713	—	—	—	—	—	—	6.65	24.49	17.60	5.91	27.13	17.60	—	—	—	—	—	—
C812	—	—	—	—	—	—	—	—	—	—	—	—	7.87	27.64	17.91	7.87	29.65	18.03
C813	—	—	—	—	—	—	8.82	27.13	20.24	8.07	29.76	20.24	7.87	30.43	20.71	—	—	—
C912	—	—	—	—	—	—	—	—	—	—	—	—	—	—	—	9.84	32.68	21.06
C913	—	—	—	—	—	—	—	—	—	—	—	—	9.84	32.28	22.56	—	—	—

<sup>(1)</sup> "H" dimension on the input side of a C303 with an TD27 or TD37 is 3.66.

<sup>(2)</sup> Also available for a NEMA 143TC frame motor.

Part No. Example  
Foot Mounting with ComTrac  
C302N0620 TD270K050-075