

Abmessungen

alle Darstellungen in der Mitte einer Rast

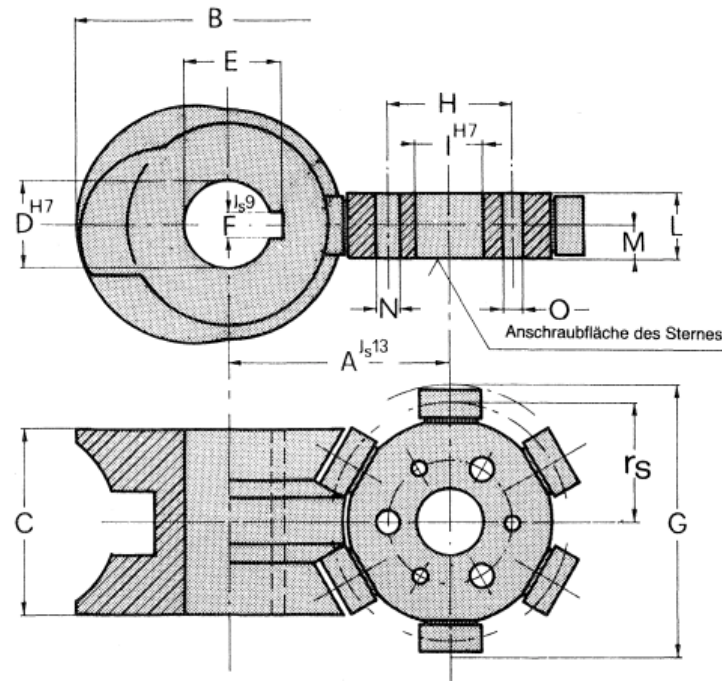

| Typ | A | Kurve | | | | | Stern | | | | | | | | | | | |
|--------------------|-----|-------|-----|----|------|----|-------|----|----|----|----|---|--------|---|--------|----------------|--|--|
| | | ØB | C | ØD | E | F | ØG | ØH | ØI | L | M | n | N Ø | n | O Ø | r _s | | |
| 160- 1A 40T-330/23 | | | | | | | | | | | | | | | | | | |
| 160- 2A 40T-180/3 | 160 | 224 | 114 | 50 | 53.8 | 14 | 173 | 75 | 50 | 40 | 20 | 3 | 13.0 | 3 | 11.5 | 73 | | |
| 160- 2A 40T-210/3 | 160 | 216 | 126 | 50 | 53.8 | 14 | 187 | 75 | 50 | 40 | 20 | 3 | 13.0 | 3 | 11.5 | 80 | | |
| 160- 2A 40T-240/3 | 160 | 216 | 126 | 50 | 53.8 | 14 | 187 | 75 | 50 | 40 | 20 | 3 | 13.0 | 3 | 11.5 | 80 | | |
| 160- 2A 47T-270/3 | 160 | 208 | 130 | 50 | 53.8 | 14 | 200 | 75 | 50 | 45 | 20 | 3 | 13.0 | 3 | 11.5 | 84 | | |
| 160- 2A 52T-300/3 | 160 | 198 | 132 | 50 | 53.8 | 14 | 207 | 75 | 50 | 50 | 25 | 3 | 13.0 | 3 | 11.5 | 87 | | |
| 160- 3A 40T-120/3 | 160 | 224 | 114 | 50 | 53.8 | 14 | 173 | 75 | 50 | 40 | 20 | 3 | 13.0 | 3 | 11.5 | 73 | | |
| 160- 3A 40T-150/3 | 160 | 216 | 126 | 50 | 53.8 | 14 | 187 | 75 | 50 | 40 | 20 | 3 | 13.0 | 3 | 11.5 | 80 | | |
| 160- 3A 47T-180/3 | 160 | 208 | 130 | 50 | 53.8 | 14 | 200 | 75 | 50 | 45 | 20 | 3 | 13.0 | 3 | 11.5 | 84 | | |
| 160- 3A 52T-210/3 | 160 | 198 | 132 | 50 | 53.8 | 14 | 207 | 75 | 50 | 50 | 25 | 3 | 13.0 | 3 | 11.5 | 87 | | |
| 160- 3A 52T-240/3 | 160 | 198 | 132 | 50 | 53.8 | 14 | 207 | 75 | 50 | 50 | 25 | 3 | 13.0 | 3 | 11.5 | 87 | | |
| 160- 3A 52T-270/3 | 160 | 198 | 130 | 50 | 53.8 | 14 | 207 | 75 | 50 | 50 | 25 | 3 | 13.0 | 3 | 11.5 | 87 | | |
| 160- 4A 28T- 90/3 | 160 | 204 | 90 | 50 | 53.8 | 14 | 165 | 75 | 50 | 30 | 15 | 4 | 10.5 | 4 | 9.5 | 73 | | |
| 160- 4A 32T-120/3 | 160 | 188 | 100 | 50 | 53.8 | 14 | 181 | 75 | 50 | 30 | 15 | 4 | 10.5 | 4 | 9.5 | 80 | | |
| 160- 4A 35T-150/3 | 160 | 178 | 108 | 50 | 53.8 | 14 | 200 | 75 | 50 | 35 | 15 | 4 | 10.5 | 4 | 9.5 | 88 | | |
| 160- 4A 35T-180/2 | 160 | 178 | 108 | 50 | 53.8 | 14 | 200 | 75 | 50 | 35 | 15 | 4 | 10.5 | 4 | 9.5 | 88 | | |
| 160- 4A 35T-210/2 | 160 | 178 | 108 | 50 | 53.8 | 14 | 200 | 75 | 50 | 35 | 15 | 4 | 10.5 | 4 | 9.5 | 88 | | |
| 160- 4A 40T-240/2 | 160 | 168 | 108 | 50 | 53.8 | 14 | 210 | 75 | 50 | 40 | 20 | 4 | 10.5 | 4 | 9.5 | 92 | | |
| 160- 4A 40T-270/2 | 160 | 168 | 112 | 50 | 53.8 | 14 | 210 | 75 | 50 | 40 | 20 | 4 | 10.5 | 4 | 9.5 | 92 | | |
| 160- 4A 47T-315/3 | 160 | 168 | 94 | 50 | 53.8 | 14 | 206 | 75 | 50 | 45 | 20 | 4 | 10.5 | 4 | 9.5 | 87 | | |
| 160- 5A 22T- 90/2 | 160 | 198 | 72 | 50 | 53.8 | 14 | 160 | 75 | 50 | 25 | 10 | 5 | 13.0 | 5 | 11.5 | 71 | | |
| 160- 5A 26T-120/2 | 160 | 178 | 84 | 50 | 53.8 | 14 | 182 | 75 | 50 | 30 | 15 | 5 | 13.0 | 5 | 11.5 | 82 | | |
| 160- 5A 28T-150/2 | 160 | 178 | 84 | 50 | 53.8 | 14 | 183 | 75 | 50 | 30 | 15 | 5 | 13.0 | 5 | 11.5 | 82 | | |
| 160- 5A 32T-180/2 | 160 | 164 | 88 | 50 | 53.8 | 14 | 201 | 75 | 50 | 30 | 15 | 5 | 13.0 | 5 | 11.5 | 90 | | |
| 160- 5A 32T-210/1 | 160 | 164 | 88 | 50 | 53.8 | 14 | 201 | 75 | 50 | 30 | 15 | 5 | 13.0 | 5 | 11.5 | 90 | | |
| 160- 5A 32T-240/1 | 160 | 164 | 88 | 50 | 53.8 | 14 | 201 | 75 | 50 | 30 | 15 | 5 | 13.0 | 5 | 11.5 | 90 | | |
| 160- 5A 35T-270/1 | 160 | 146 | 96 | 50 | 53.8 | 14 | 222 | 75 | 50 | 35 | 15 | 5 | 13.0 | 5 | 11.5 | 99 | | |
| 160- 6A 35T- 90/1 | 160 | 228 | 114 | 50 | 53.8 | 14 | 168 | 75 | 50 | 35 | 15 | 3 | 13.0 | 3 | 11.5 | 72 | | |
| 160- 6A 40T-120/1 | 160 | 216 | 126 | 50 | 53.8 | 14 | 187 | 75 | 50 | 40 | 20 | 3 | 13.0 | 3 | 11.5 | 80 | | |
| 160- 6A 47T-150/1 | 160 | 206 | 132 | 50 | 53.8 | 14 | 200 | 75 | 50 | 45 | 20 | 3 | 13.0 | 3 | 11.5 | 84 | | |
| 160- 6A 52T-180/1 | 160 | 198 | 132 | 50 | 53.8 | 14 | 207 | 75 | 50 | 50 | 25 | 3 | 13.0 | 3 | 11.5 | 87 | | |
| 160- 6A 52T-210/1 | 160 | 198 | 130 | 50 | 53.8 | 14 | 207 | 75 | 50 | 50 | 25 | 3 | 13.0 | 3 | 11.5 | 87 | | |
| 160- 6A 52T-240/1 | 160 | 198 | 130 | 50 | 53.8 | 14 | 207 | 75 | 50 | 50 | 25 | 3 | 13.0 | 3 | 11.5 | 87 | | |
| 160- 6A 52T-270/1 | 160 | 198 | 128 | 50 | 53.8 | 14 | 207 | 75 | 50 | 50 | 25 | 3 | 13.0 | 3 | 11.5 | 87 | | |
| 160- 8A 32T- 90/1 | 160 | 188 | 98 | 50 | 53.8 | 14 | 181 | 75 | 50 | 30 | 15 | 4 | 10.5 | 4 | 9.5 | 80 | | |
| 160- 8A 35T-120/1 | 160 | 178 | 108 | 50 | 53.8 | 14 | 200 | 75 | 50 | 35 | 15 | 4 | 10.5 | 4 | 9.5 | 88 | | |
| 160- 8A 40T-150/1 | 160 | 168 | 110 | 50 | 53.8 | 14 | 210 | 75 | 50 | 40 | 20 | 4 | 10.5 | 4 | 9.5 | 92 | | |
| 160- 8A 40T-180/1 | 160 | 168 | 110 | 50 | 53.8 | 14 | 210 | 75 | 50 | 40 | 20 | 4 | 10.5 | 4 | 9.5 | 92 | | |
| 160- 8A 47T-210/1 | 160 | 168 | 94 | 50 | 53.8 | 14 | 206 | 75 | 50 | 45 | 20 | 4 | 10.5 | 4 | 9.5 | 87 | | |
| 160- 8A 47T-240/1 | 160 | 168 | 94 | 50 | 53.8 | 14 | 206 | 75 | 50 | 45 | 20 | 4 | 10.5 | 4 | 9.5 | 87 | | |
| 160- 8A 47T-270/1 | 160 | 168 | 94 | 50 | 53.8 | 14 | 206 | 75 | 50 | 45 | 20 | 4 | 10.5 | 4 | 9.5 | 87 | | |

Abmessungen

alle Darstellungen in der Mitte einer Rast

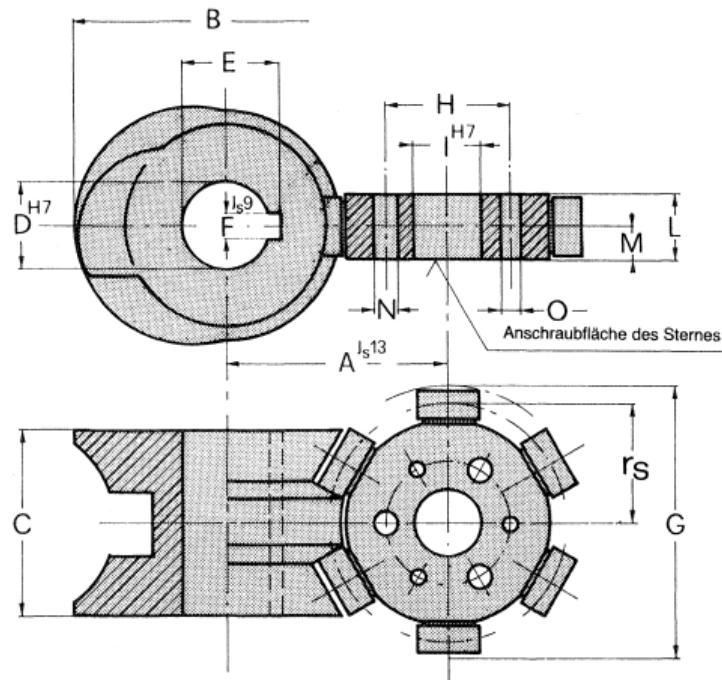

| Typ | A | ØB | Kurve | | | Stern | | | | | | | | | | |
|-------------------|-----|-----|-------|----|------|-------|-----|----|----|----|----|---|--------|---|--------|----------------|
| | | | C | ØD | E | F | ØG | ØH | ØI | L | M | n | N Ø | n | O Ø | r _s |
| 160-10A 30T- 90/1 | 160 | 164 | 88 | 50 | 53.8 | 14 | 201 | 75 | 50 | 30 | 15 | 5 | 13.0 | 5 | 11.5 | 90 |
| 160-10A 30T-120/1 | 160 | 164 | 88 | 50 | 53.8 | 14 | 201 | 75 | 50 | 30 | 15 | 5 | 13.0 | 5 | 11.5 | 90 |
| 160-10A 35T-150/1 | 160 | 146 | 96 | 50 | 53.8 | 14 | 222 | 75 | 50 | 35 | 15 | 5 | 13.0 | 5 | 11.5 | 99 |
| 160-10A 40T-180/1 | 160 | 138 | 90 | 50 | 53.8 | 14 | 224 | 75 | 50 | 40 | 20 | 5 | 13.0 | 5 | 11.5 | 99 |
| 160-10A 40T-210/1 | 160 | 138 | 90 | 50 | 53.8 | 14 | 224 | 75 | 50 | 40 | 20 | 5 | 13.0 | 5 | 11.5 | 99 |
| 160-10A 40T-240/1 | 160 | 138 | 90 | 50 | 53.8 | 14 | 224 | 75 | 50 | 40 | 20 | 5 | 13.0 | 5 | 11.5 | 99 |
| 160-10A 40T-270/1 | 160 | 138 | 90 | 50 | 53.8 | 14 | 224 | 75 | 50 | 40 | 20 | 5 | 13.0 | 5 | 11.5 | 99 |
| 160-12A 26T- 90/1 | 160 | 154 | 76 | 40 | 43.3 | 12 | 200 | 75 | 50 | 30 | 15 | 3 | 13.0 | 3 | 11.5 | 91 |
| 160-12A 30T-120/1 | 160 | 133 | 82 | 40 | 43.3 | 12 | 221 | 75 | 50 | 30 | 15 | 3 | 13.0 | 3 | 11.5 | 100 |
| 160-12A 32T-150/1 | 160 | 133 | 82 | 40 | 43.3 | 12 | 221 | 75 | 50 | 30 | 15 | 3 | 13.0 | 3 | 11.5 | 100 |
| 160-12A 35T-180/1 | 160 | 121 | 82 | 40 | 43.3 | 12 | 237 | 75 | 50 | 35 | 15 | 3 | 13.0 | 3 | 11.5 | 107 |
| 160-12A 35T-210/1 | 160 | 120 | 82 | 40 | 43.3 | 12 | 237 | 75 | 50 | 35 | 15 | 3 | 13.0 | 3 | 11.5 | 107 |
| 160-12A 35T-240/1 | 160 | 120 | 82 | 40 | 43.3 | 12 | 237 | 75 | 50 | 35 | 15 | 3 | 13.0 | 3 | 11.5 | 107 |
| 160-12A 35T-270/1 | 160 | 120 | 82 | 40 | 43.3 | 12 | 237 | 75 | 50 | 35 | 15 | 3 | 13.0 | 3 | 11.5 | 107 |
| 160-16A 22T- 90/1 | 160 | 132 | 62 | 40 | 43.3 | 12 | 218 | 75 | 50 | 25 | 10 | 4 | 10.5 | 4 | 9.5 | 100 |
| 160-16A 24T-120/1 | 160 | 132 | 62 | 40 | 43.3 | 12 | 218 | 75 | 50 | 25 | 10 | 4 | 10.5 | 4 | 9.5 | 100 |
| 160-16A 26T-150/1 | 160 | 108 | 68 | 40 | 43.3 | 12 | 242 | 75 | 50 | 35 | 15 | 4 | 10.5 | 4 | 9.5 | 112 |
| 160-16A 28T-180/1 | 160 | 108 | 68 | 40 | 43.3 | 12 | 243 | 75 | 50 | 35 | 15 | 4 | 10.5 | 4 | 9.5 | 112 |
| 160-16A 30T-210/1 | 160 | 105 | 62 | 40 | 43.3 | 12 | 249 | 75 | 50 | 35 | 15 | 4 | 10.5 | 4 | 9.5 | 114 |
| 160-16A 30T-240/1 | 160 | 105 | 62 | 40 | 43.3 | 12 | 249 | 75 | 50 | 35 | 15 | 4 | 10.5 | 4 | 9.5 | 114 |
| 160-16A 30T-270/1 | 160 | 105 | 62 | 40 | 43.3 | 12 | 249 | 75 | 50 | 35 | 15 | 4 | 10.5 | 4 | 9.5 | 114 |
| 160-20A 19T- 90/1 | 160 | 118 | 54 | 40 | 43.3 | 12 | 231 | 75 | 50 | 25 | 10 | 5 | 13.0 | 5 | 11.5 | 107 |
| 160-20A 19T-120/1 | 160 | 118 | 54 | 40 | 43.3 | 12 | 231 | 75 | 50 | 25 | 10 | 5 | 13.0 | 5 | 11.5 | 107 |
| 160-20A 22T-150/1 | 160 | 94 | 58 | 40 | 43.3 | 12 | 256 | 75 | 50 | 30 | 15 | 5 | 13.0 | 5 | 11.5 | 119 |
| 160-20A 24T-180/1 | 160 | 94 | 54 | 40 | 43.3 | 12 | 256 | 75 | 50 | 30 | 15 | 5 | 13.0 | 5 | 11.5 | 119 |
| 160-20A 24T-210/1 | 160 | 94 | 54 | 40 | 43.3 | 12 | 256 | 75 | 50 | 30 | 15 | 5 | 13.C | 5 | 11.5 | 119 |
| 160-20A 24T-240/1 | 160 | 94 | 54 | 40 | 43.3 | 12 | 256 | 75 | 50 | 30 | 15 | 5 | 13.0 | 5 | 11.5 | 119 |
| 160-20A 26T-270/1 | 160 | 94 | 54 | 40 | 43.3 | 12 | 256 | 75 | 50 | 35 | 15 | 5 | 13.0 | 5 | 11.5 | 119 |
| 160-24A 16T- 90/1 | 160 | 114 | 44 | 40 | 43.3 | 12 | 230 | 75 | 50 | 25 | 10 | 3 | 13.0 | 3 | 11.5 | 108 |
| 160-24A 19T-120/1 | 160 | 94 | 46 | 40 | 43.3 | 12 | 255 | 75 | 50 | 25 | 10 | 3 | 13.0 | 3 | 11.5 | 119 |
| 160-24A 19T-150/1 | 160 | 94 | 46 | 40 | 43.3 | 12 | 255 | 75 | 50 | 25 | 10 | 3 | 13.0 | 3 | 11.5 | 119 |
| 160-24A 19T-180/1 | 160 | 94 | 46 | 40 | 43.3 | 12 | 255 | 75 | 50 | 25 | 10 | 3 | 13.0 | 3 | 11.5 | 119 |
| 160-24A 19T-210/1 | 160 | 94 | 46 | 40 | 43.3 | 12 | 255 | 75 | 50 | 25 | 10 | 3 | 13.0 | 3 | 11.5 | 119 |
| 160-24A 22T-240/1 | 160 | 94 | 46 | 40 | 43.3 | 12 | 256 | 75 | 50 | 30 | 15 | 3 | 13.0 | 3 | 11.5 | 119 |
| 160-24A 22T-270/1 | 160 | 94 | 46 | 40 | 43.3 | 12 | 256 | 75 | 50 | 30 | 15 | 3 | 13.0 | 3 | 11.5 | 119 |

zulässige Belastungen

| Stationen | Schaltwinkel | M_{stat} zulässiges statisches Abtriebsmoment in Nm | M_{dyn} zulässiges dynamisches Abtriebsmoment in Nm | | | | | |
|--------------------------------|--------------|---|--|-----------------------|-----------------------|-----------------------|-----------------------|-----------------------|
| | | | 50 min ⁻¹ | 100 min ⁻¹ | 200 min ⁻¹ | 350 min ⁻¹ | 500 min ⁻¹ | 800 min ⁻¹ |
| | | | 1 (360° pro Schritt) | 330 | 826 | 739 | 598 | 477 |
| 2 (180° pro Schritt) | 180 | 839 | 838 | 681 | 540 | 420 | 286 | 104 |
| | 210 | 909 | 894 | 723 | 574 | 448 | 311 | 125 |
| | 240 | 974 | 920 | 745 | 595 | 4-75 | 353 | 198 |
| | 270 | 1439 | 1327 | 1075 | 861 | 695 | 534 | 339 |
| | 300 | 1933 | 1723 | 1396 | 1122 | 913 | 720 | 497 |
| 3 (120° pro Schritt) | 120 | 839 | 838 | 768 | 604 | 456 | 277 | 20 |
| | 150 | 943 | 942 | 829 | 656 | 506 | 336 | 101 |
| | 180 | 1439 | 1437 | 1212 | 967 | 768 | 561 | 295 |
| | 210 | 1975 | 1959 | 1587 | 1272 | 1028 | 792 | 508 |
| | 240 | 2083 | 1986 | 1610 | 1294 | 1058 | 843 | 601 |
| | 270 | 2169 | 1996 | 1618 | 1304 | 1074 | 874 | 660 |
| 4 (90° pro Schritt) | 90 | 425 | 424 | 419 | 342 | 238 | 97 | - |
| | 120 | 674 | 672 | 639 | 503 | 382 | 239 | 33 |
| | 150 | 856 | 855 | 823 | 651 | 504 | 338 | 108 |
| | 180 | 799 | 731 | 592 | 473 | 378 | 280 | 158 |
| | 210 | 863 | 754 | 611 | 491 | 398 | 312 | 210 |
| | 240 | 1158 | 1017 | 825 | 664 | 543 | 435 | 315 |
| | 270 | 1216 | 1031 | 836 | 674 | 556 | 455 | 348 |
| | 315 | 1878 | 1825 | 1481 | 1197 | 996 | 835 | 680 |
| 5 (72° pro Schritt) | 90 | 313 | 313 | 279 | 220 | 165 | 99 | 03 |
| | 120 | 450 | 449 | 382 | 301 | 230 | 147 | 28 |
| | 150 | 524 | 523 | 424 | 338 | 270 | 199 | 110 |
| | 180 | 779 | 733 | 594 | 476 | 385 | 298 | 193 |
| | 210 | 788 | 657 | 533 | 429 | 351 | 282 | 204 |
| | 240 | 832 | 667 | 541 | 436 | 360 | 295 | 228 |
| | 270 | 999 | 844 | 68 5 | 552 | 455 | 372 | 284 |
| 6 (60° pro Schritt) | 90 | 649 | 586 | 474 | 377 | 295 | 207 | 88 |
| | 120 | 954 | 837 | 678 | 542 | 436 | 330 | 200 |
| | 150 | 1482 | 1229 | 996 | 802 | 656 | 525 | 378 |
| | 180 | 2051 | 1608 | 1304 | 1052 | 870 | 716 | 557 |
| | 210 | 2166 | 1621 | 1315 | 1063 | 884 | 740 | 600 |
| | 240 | 2251 | 1618 | 1314 | 1063 | 887 | 750 | 624 |
| | 270 | 2315 | 1607 | 1305 | 1056 | 884 | 753 | 636 |
| 8 (45° pro Schritt) | 90 | 660 | 638 | 516 | 411 | 324 | 231 | 109 |
| | 120 | 865 | 830 | 672 | 538 | 433 | 329 | 202 |
| | 150 | 1205 | 1132 | 918 | 738 | 604 | 483 | 348 |
| | 180 | 1286 | 1143 | 927 | 748 | 619 | 509 | 397 |
| | 210 | 1824 | 1510 | 1226 | 992 | 827 | 699 | 579 |
| | 240 | 1870 | 1487 | 1207 | 978 | 818 | 696 | 587 |
| | 270 | 1904 | 1462 | 1187 | 961 | 806 | 690 | 58 9 |

zulässige Belastungen

| Stationen | Schaltwinkel | M_{stat} zulässiges statisches Abtriebsmoment in Nm | M_{dyn} zulässiges dynamisches Abtriebsmoment in Nm | | | | | |
|----------------------------------|--------------|--|---|-----------------------|-----------------------|-----------------------|-----------------------|-----------------------|
| | | | 50 min ⁻¹ | 100 min ⁻¹ | 200 min ⁻¹ | 350 min ⁻¹ | 500 min ⁻¹ | 800 min ⁻¹ |
| | | | | | | | | |
| 10 (36° pro Schritt) | 90 | 671 | 670 | 581 | 461 | 360 | 250 | 100 |
| | 120 | 762 | 749 | 607 | 487 | 395 | 308 | 206 |
| | 150 | 1042 | 1041 | 852 | 685 | 561 | 448 | 323 |
| | 180 | 1401 | 1376 | 1117 | 901 | 746 | 617 | 486 |
| | 210 | 1460 | 1369 | 1111 | 898 | 748 | 628 | 513 |
| | 240 | 1502 | 1354 | 1099 | 889 | 743 | 629 | 525 |
| | 270 | 1533 | 1334 | 1083 | 877 | 734 | 626 | 530 |
| 12 (30° pro Schritt) | 90 | 560 | 559 | 528 | 420 | 330 | 233 | 104 |
| | 120 | 821 | 821 | 724 | 580 | 469 | 362 | 234 |
| | 150 | 971 | 971 | 804 | 648 | 534 | 434 | 328 |
| | 180 | 1184 | 1184 | 1011 | 815 | 674 | 555 | 433 |
| | 210 | 1237 | 1236 | 1008 | 815 | 678 | 567 | 460 |
| | 240 | 1274 | 1230 | 998 | 808 | 674 | 570 | 474 |
| | 270 | 1302 | 1214 | 985 | 798 | 668 | 568 | 480 |
| 16 (22.5° pro Schritt) | 90 | 509 | 509 | 507 | 438 | 347 | 252 | 130 |
| | 120 | 636 | 636 | 620 | 499 | 409 | 327 | 236 |
| | 150 | 752 | 751 | 741 | 596 | 486 | 385 | 270 |
| | 180 | 827 | 826 | 785 | 633 | 522 | 428 | 330 |
| | 210 | 1077 | 1076 | 949 | 767 | 638 | 534 | 435 |
| | 240 | 1105 | 1105 | 936 | 757 | 632 | 535 | 445 |
| | 270 | 1127 | 1126 | 921 | 746 | 624 | 531 | 449 |
| 20 (18° pro Schritt) | 90 | 423 | 422 | 420 | 395 | 311 | 220 | 99 |
| | 120 | 465 | 465 | 464 | 403 | 328 | 257 | 175 |
| | 150 | 648 | 647 | 646 | 578 | 474 | 379 | 275 |
| | 180 | 772 | 772 | 771 | 646 | 535 | 443 | 349 |
| | 210 | 80G | 799 | 791 | 639 | 533 | 447 | 366 |
| | 240 | 819 | 819 | 778 | 630 | 526 | 446 | 372 |
| | 270 | 909 | 909 | 844 | 684 | 572 | 487 | 411 |
| 24 (15° pro Schritt) | 90 | 286 | 285 | 283 | 277 | 222 | 150 | 51 |
| | 120 | 489 | 489 | 488 | 482 | 392 | 305 | 201 |
| | 150 | 523 | 523 | 522 | 486 | 400 | 325 | 245 |
| | 180 | 544 | 544 | 544 | 480 | 399 | 331 | 265 |
| | 210 | 559 | 558 | 558 | 472 | 393 | 331 | 273 |
| | 240 | 742 | 742 | 741 | 613 | 513 | 436 | 368 |
| | 270 | 751 | 751 | 740 | 599 | 503 | 430 | 367 |

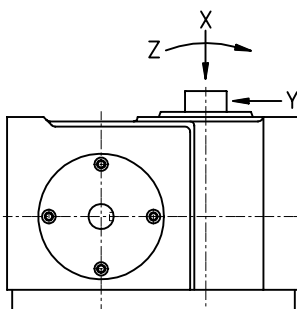

| zulässige Kräfte auf die Abtriebswelle | | |
|--|---------|---------|
| X | Y | Z |
| + 39000 N - 10200 N | 29000 N | 1800 Nm |