

Worm gear screw jacks

3.6 HSE range dimension plans

3.6.1 Type 1

3.6.1.1 Standard

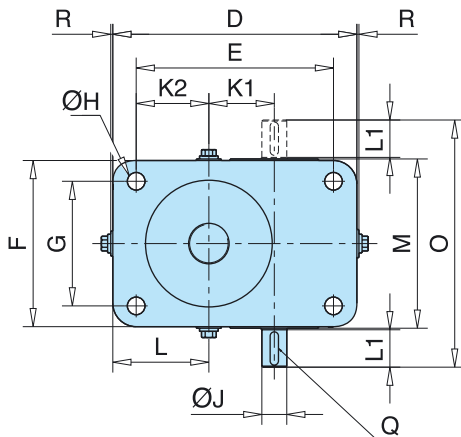
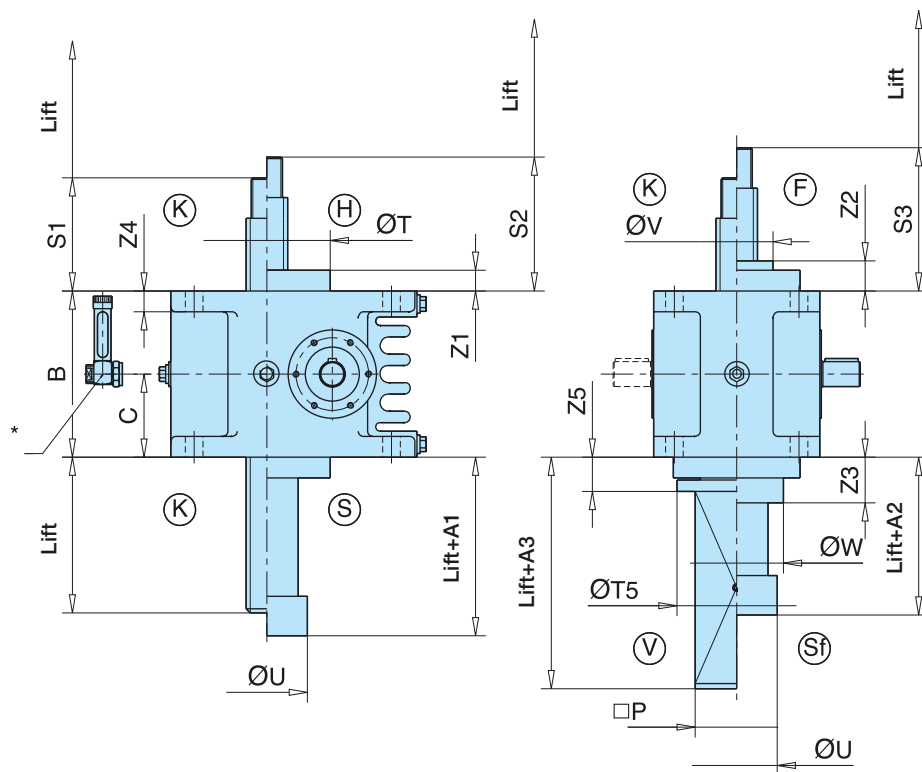
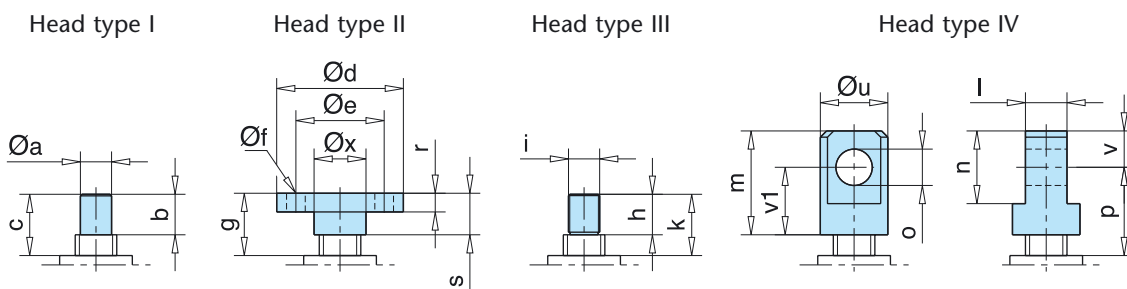

Versions possibles:

- K — Short cover
- H — High cover
- F — Guide ring
- S — protection tube
- Sf — protection tube with guide ring
- V — Anti-turn device

* Oil gauge dimension plan see section 3.6.2 (HSE type 2)

Worm gear screw jacks

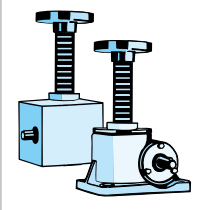

3.6 HSE range dimension plans

Size Spindle	31 Tr 18x4	36 Tr 22x5	50 Tr 40x8	63 Tr 50x9	80 Tr 60x12	100 Tr 70x12	125 Tr100x16	140 Tr 120x16	200 Tr 160x20
A 1	22	22	22	22	22	22	22	22	22
A 2	39	44	46	52	61	71	76	86	101
A 3	98	104	117	123	136	152	154	179	199
B	80	105	130	160	200	230	300	350	450
C	40	52,5	65	80	100	115	150	175	225
D	117	138	175	235	275	330	410	490	680
E	95	110	140	190	220	270	330	390	550
F	80	105	130	160	200	230	300	350	460
G	62	80	100	120	150	175	230	260	330
Ø H	9	9	13	17	21	28	39	46	66
Ø J _{k6}	10	14	16	24	32	38	42	50	70
K 1	31	36	50	63	80	100	125	140	200
K 2	31	40	50	70	75	87,5	110	130	185
L	42	54	67,5	92,5	102,5	117,5	150	180	250
L 1	15	18	28	36	58	58	82	82	105
M	83	108	133	163	204	235	305	355	470
N	86	112	136	166	206	240	310	360	472
O	116	148	192	238	322	356	474	524	682
P	30	40	70	80	80	100	140	180	220
Q	3x3x12	5x5x16	5x5x25	8x7x32	10x8x50	10x8x50	12x8x70	14x9x70	20x12x100
R	3	2	2	2	2	2	5	5	5
S 1	43	45	50	60	70	75	100	120	140
S 2	58	61	68	80	95	105	135	160	190
S 3	66	69	76	89	109	124	154	184	219
Ø T f7	62	72	92	122	152	182	222	262	352
Ø T5	50	-	100	115	130	-	200	260	310
Ø U	28	37	66	82	78	92	136	143	198
Ø V	35	40	60	70	100	125	160	195	240
Ø W	45	50	80	100	120	150	180	220	290
Z 1	15	16	18	20	25	30	35	40	50
Z 2	23	24	26	29	39	49	54	64	79
Z 3	29	34	39	44	54	64	74	84	109
Z 4	10	12	15	20	25	28	35	45	60
Z 5	27	-	28	33	40	-	54	63	73
Head I									
Ø a _{k6}	12	15	20	30	40	50	80	95	130
b	17	24	29	39	49	54	79	99	119
c	37	44	49	59	69	74	99	119	139
Head II									
Ø d	62	72	92	122	150	182	222	262	352
Ø e	45	50	65	85	105	135	170	205	270
Ø f	4xØ 6,6	4xØ 9	4xØ 14	4xØ 18	4xØ 22	6xØ 26	8xØ 30	8xØ 33	8xØ 45
g	43	45	50	60	70	75	100	120	140
r	8	10	12	18	20	25	30	35	50
s	18	25	30	40	50	55	80	100	120
Ø x	20	30	35	50	65	85	115	140	185
Head III									
h	17	24	29	39	49	54	79	99	119
i	M 12x1,5	M 16x1,5	M 20x1,5	M 30x2	M 42x3	M 56x3	M 80x3	M 100x4	M 140x4
k	37	44	49	59	69	74	99	119	139
Head IV									
l - 0,2	20	25	30	40	60	75	100	120	160
m	50	60	70	100	130	150	230	300	360
n	30	40	50	70	100	120	160	200	280
Ø o ^{H8}	15	20	25	35	50	60	80	100	140
p	55	60	65	85	100	110	170	220	240
Ø u	30	40	50	65	90	110	140	170	220
v	15	20	25	35	50	60	80	100	140
v ₁	35	40	45	65	80	90	150	200	220