

Parallel gripper with T-slot guide

Advantages, benefits, comparisons and tips! Stacks of information all about this product are on page 17.

Gripping force as a function of jaw length [N]

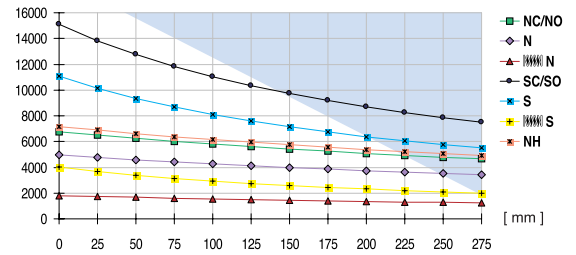

Colored area: increased wear and tear to be expected

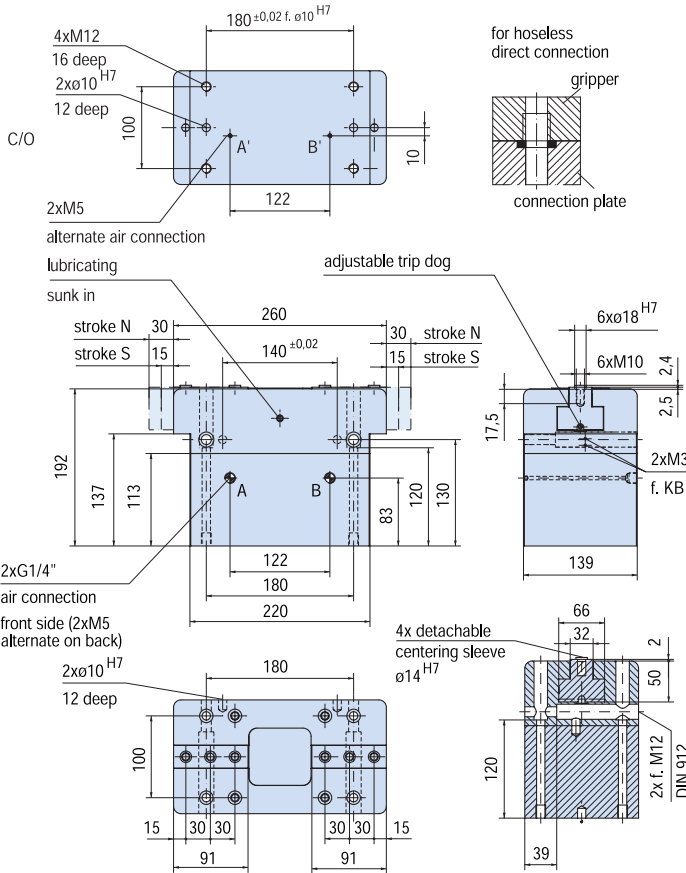
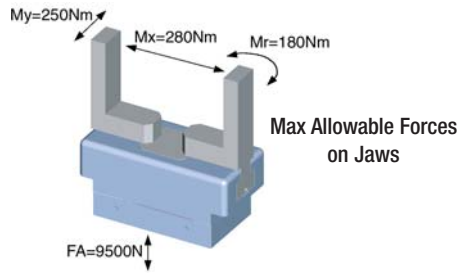
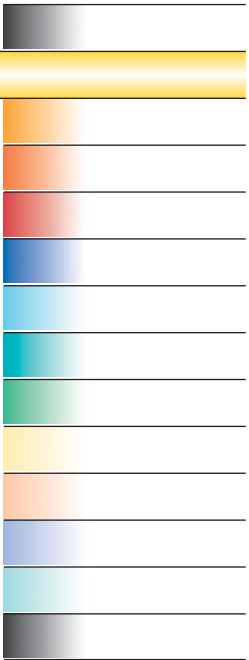

N/S NH

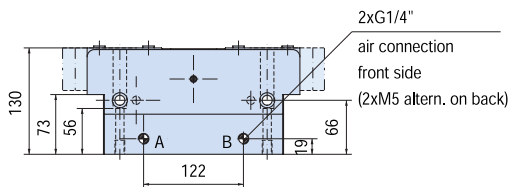

Order no.:						
GP430 N	GP430 NC	GP430 NO	GP430 S	GP430 SC	GP430 SO	GP430 NH
Drive:						
pneum.	pneum.	pneum.	pneum.	pneum.	pneum.	hydr.
Stroke per jaw [mm]:						
30	30	30	15	15	15	30
Gripping force in closing and opening [N]:						
5000	-	-	11000	-	-	7000
Gripping force in closing [N]:						
-	6900	-	-	15000	-	-
Gripping force in opening [N]:						
-	-	6900	-	-	15000	-
Self-locking via:						
DSV1/8	Spring	Spring	DSV1/8	Spring	Spring	-
Closing time/opening time [s]:						
0,2	0,3	0,3	0,2	0,3	0,3	0,8
Repeatability ± [mm]:						
0,025	0,025	0,025	0,025	0,025	0,025	0,025
Min./max. operating pressure [bar]:						
3 / 8	5 / 8	5 / 8	3 / 8	5 / 8	5 / 8	10 / 40
Air volume per cycle [cm³]:						
730	1020	1020	730	1020	1020	-
Oil volume per cycle [cm³]:						
-	-	-	-	-	-	230
Min./max. operating temperature [°C]:						
5 / 80	5 / 80	5 / 80	5 / 80	5 / 80	5 / 80	5 / 80
Temp. resistant version up to 150° C [add to part number]:						
T3	T3	T3	T3	T3	T3	T3
Piston diameter [mm]:						
115	115	115	115	115	115	64
Weight [kg]:						
14	18,9	18,9	14	18,9	18,9	14

All data measured at 6 bar (hydr. 30 bar).

See Page 17 for Accessory list.