

Compliant finger gripper

Advantages, benefits, comparisons and tips!
Stacks of information all about this product are
on page 155.

Gripping force as a function of jaw length

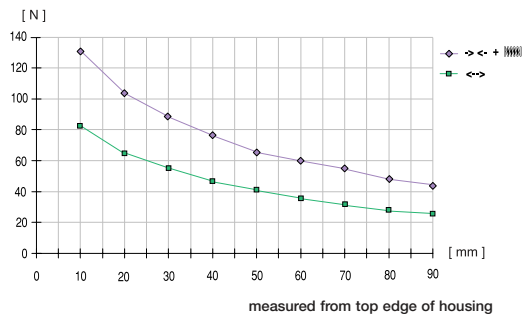

Order no.:

| GZ25-35 | GZ55-65 | | | | |
|--|---------|--|--|--|--|
| D | D | | | | |
| Drive: | | | | | |
| pneum. | pneum. | | | | |
| Stroke per jaw [mm]: | | | | | |
| 5 | 5 | | | | |
| Stroke per jaw [°]: | | | | | |
| 4 | 4 | | | | |
| Gripping torque in closing [Nm]: | | | | | |
| 5,4 | 5,4 | | | | |
| Gripping torque in opening [Nm]: | | | | | |
| 3,4 | 3,4 | | | | |
| Self-locking via: | | | | | |
| Spring | Spring | | | | |
| Closing time/opening time [s]: | | | | | |
| 0,2/0,2 | 0,2/0,3 | | | | |
| Repeatability ± [mm]: | | | | | |
| 0,1 | 0,1 | | | | |
| Min./max. operating pressure [bar]: | | | | | |
| 4/8 | 4/8 | | | | |
| Air volume per cycle [cm³]: | | | | | |
| 12 | 13 | | | | |
| Min./max. operating temperature [°C]: | | | | | |
| 5/80 | 5/80 | | | | |
| Temp. resistant version up to 150° C [add to part number]: | | | | | |
| TS | TS | | | | |
| Weight [kg]: | | | | | |
| 0,265 | 0,38 | | | | |

All data measured at 6 bar.

* Measured at 10 mm from top edge of housing.

See Page 155 for Accessory list.

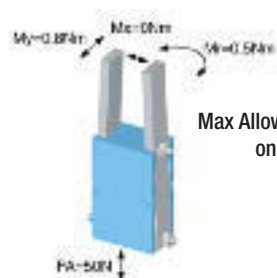

Max Allowable Forces
on Jaws

Sommer-automatic

Grippers

Separators

Swivel units

Rotating jaws

Axial compensators

Tool changers

Linear cylinders

Shock absorbers

Rotary cylinders

Air vane motors

Vacuum components

Accessories

Quick finder

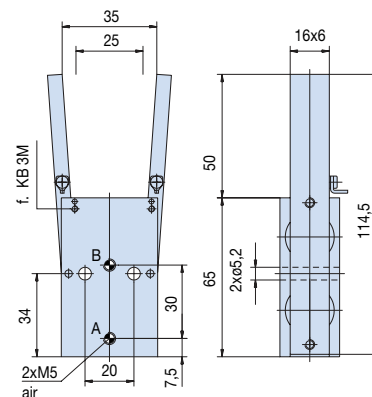
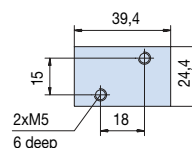

GZ25-35D

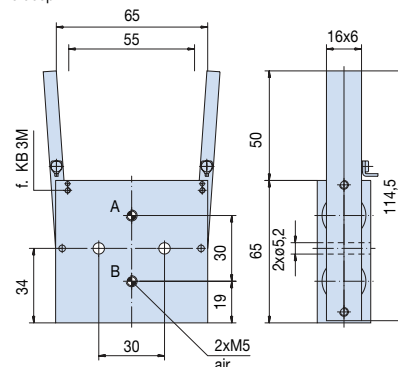
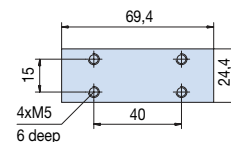

GZ55-65D