

- Sommer-automatic
- Grippers**
- Separators
- Swivel units
- Rotating jaws
- Axial compensators
- Tool changers
- Linear cylinders
- Shock absorbers
- Rotary cylinders
- Air vane motors
- Vacuum components
- Accessories
- Quick finder

Flow control valves are recommended (especially when using longer fingers) in order to reduce the shock to jaw

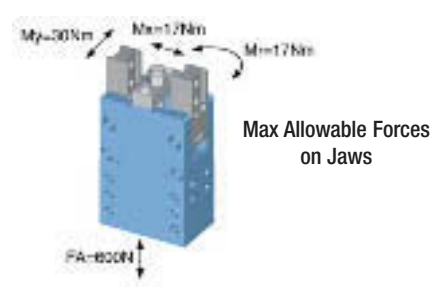

Pivoting arm gripper

Advantages, benefits, comparisons and tips! Stacks of information all about this product are on page 147.

Gripping force as a function of opening angle

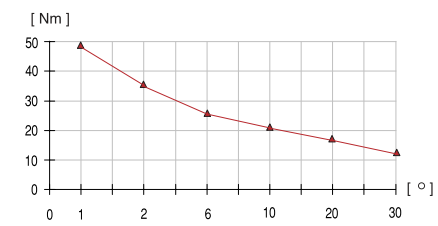

Gripping force as a function of jaw length (measured at 1° opening angle)

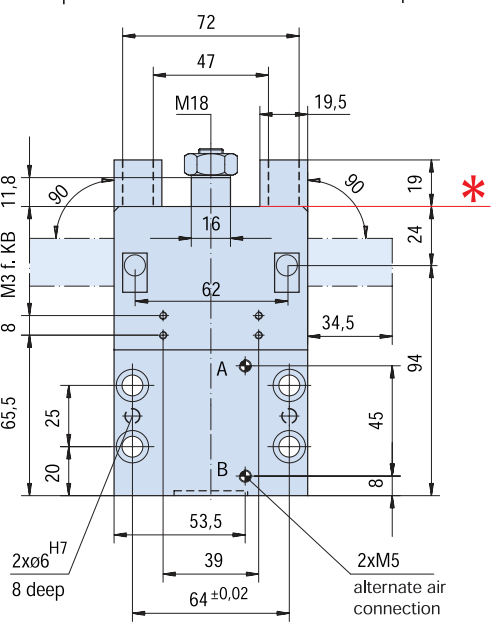
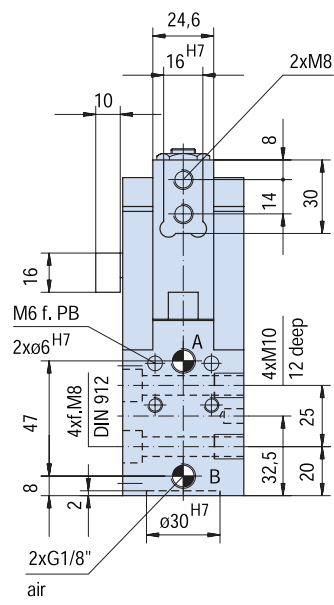
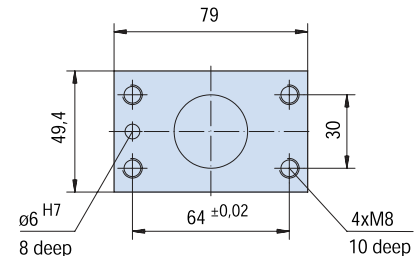
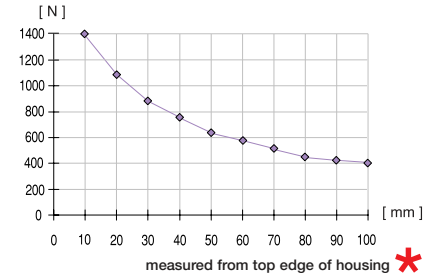

Order no.:				
GK40 N				
Drive:				
pneum.				
Stroke per jaw [°]:				
90				
Gripping force in closing [N]**:				
1400				
Gripping torque in closing [Nm]:				
48				
Self-locking via:				
mech.				
Closing time/opening time [s]:				
0,4				
Repeatability ± [mm]:				
0,1				
Min./max. operating pressure [bar]:				
4/10				
Air volume per cycle [cm³]:				
78				
Min./max. operating temperature. [°C]:				
5/80				
Temp. resistant version up to 150°C [add to part number]:				
T2				
Piston diameter [mm]:				
40				
Weight [kg]:				
1,67				

All data measured at 6 bar.

See Page 147 for Accessory list.

** Measured at 10 mm from top edge of housing.