



Parallel gripper		Three-jaw gripper		Angle gripper		Internal-hole gripper		Other grippers		Electric gripper		
SCH20	SCH23	ST36	ST40	ZK22	ZK33	GS65	RG0-30	RG10-60	SPG30-95	GF40	GF41	HM

# Needle gripper

Advantages, benefits, comparisons and tips!  
Stacks of information all about this product are on page 171.

Order no.:	
ST36	ST40
Drive	
pneum.	pneum.
Stroke adjustable [mm]:	
0-1,5	0-2
Number of needles (pcs):	
20	40
Needle diameter [mm]:	
0,69	0,69
Gripping force in extraction [N]:	
55	55
Self-locking via:	
DSV 1/8	DSV 1/8
Extend/retract time [s]:	
0,03	0,03
Repeatability ± [mm]:	
0,01	0,01
Min./max. operating pressure [bar]:	
4/8	4/8
Air volume per cycle [cm³]:	
1	3
Min./max. operating temperature. [°C]:	
5/80	5/80
temp. resistant version up to 150° C [add to part number]:	
T1	T1
Weight [kg]:	
0,2	0,5

All data measured at 6 bar.

See Page 171 for Accessory list.



Sommer-automatic
Grippers
Separators
Swivel units
Rotating jaws
Axial compensators
Tool changers
Linear cylinders
Shock absorbers
Rotary cylinders
Air vane motors
Vacuum components
Accessories
Quick finder

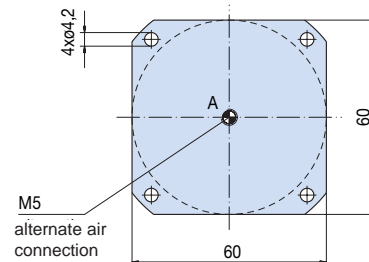
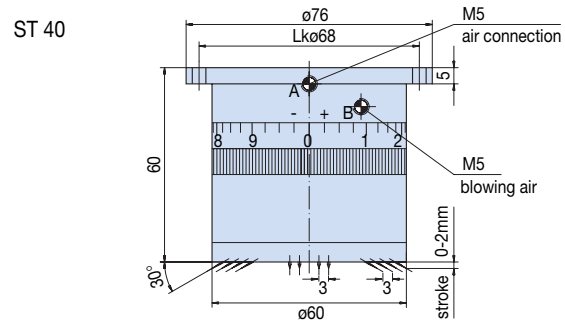
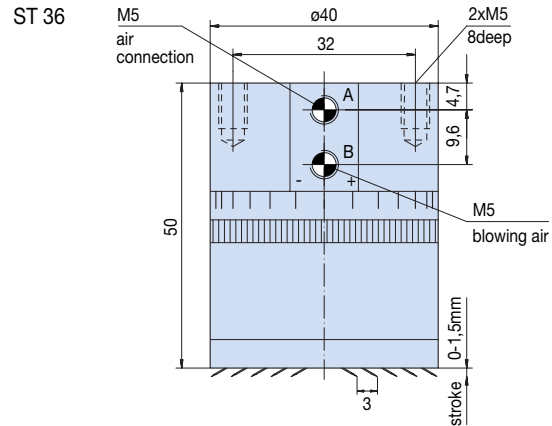

Parallel gripper		Three-jaw gripper		Angle gripper	Internal-hole gripper	Other grippers		Electric gripper				
SCH20	SCH23	ST36	ST40	<b>ZK22</b>	ZK33	GS65	RG0-30	RG10-60	SPG30-95	GF40	GF41	HM

# Cutting/Toggle tong

Advantages, benefits, comparisons and tips! Stacks of information all about this product are on page 171.

## Gripping force as a function of opening angle

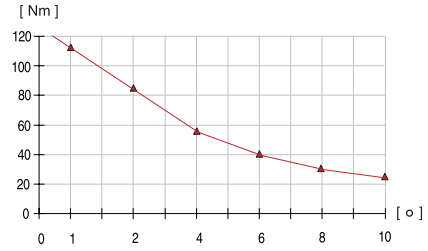

## Gripping force as a function of jaw length

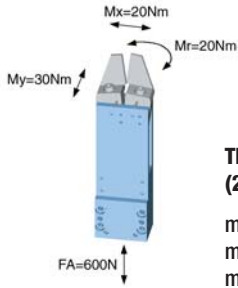
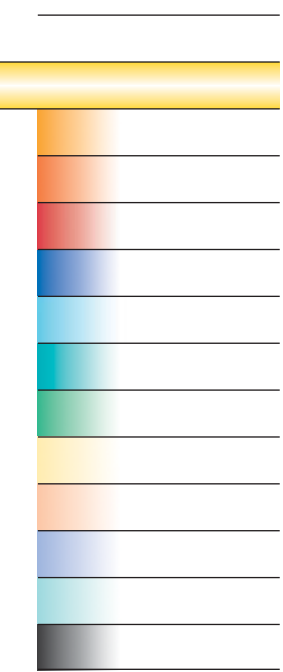
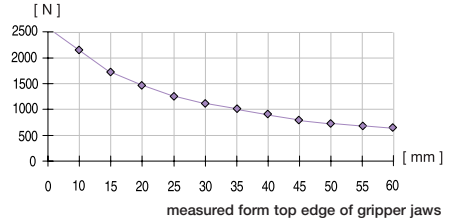

**These wire thicknesses can be cut (25 mm from top edge of gripper)**

- max. Ø 3,5 mm Copper wire
- max. Ø 3,0 mm Brass wire
- max. Ø 2,0 mm Steel wire (St52)

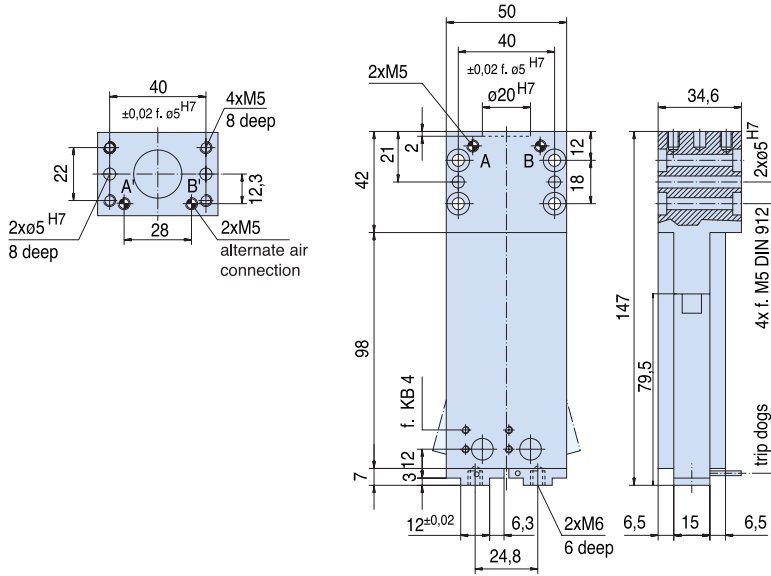

Order no.:				
<b>BK22</b>	Knife 1	Knife 2	Knife 3	<b>UB22</b>

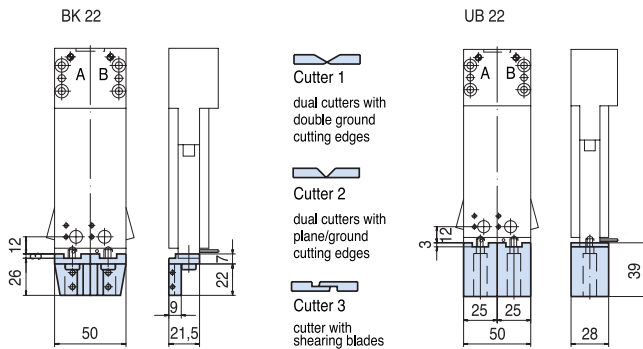

Order no.:				
<b>ZK22</b>				
Drive:				
pneum.				
Stroke per jaw [°]:				
7,5				
Gripping force in closing [N]:				
2150				
Gripping torque in closing [Nm]*:				
58				
Self-locking via:				
mech.				
Closing time/opening time [s]:				
0,15				
Repeatability ± [mm]:				
0,1				
Min./max. operating pressure [bar]:				
3/8				
Air volume per cycle [cm³]:				
10				
Min./max. operating temperature [°C]:				
5/80				
Temp. resistant version up to 150° C [add to part number]:				
T2				
Piston diameter [mm]:				
30				
Weight [kg]:				
0,62				

All data measured at 6 bar.

All data measured at 10 mm from top edge of gripper jaw.

\* measured at 1° opening angle/jaw.

**See Page 171 for Accessory list.**

Parallel gripper		Three-jaw gripper		Angle gripper	Internal-hole gripper	Other grippers			Electric gripper			
SCH20	SCH23	ST36	ST40	ZK22	<b>ZK33</b>	GS65	RG0-30	RG10-60	SPG30-95	GF40	GF41	HM

# Cutting/Toggle tong

Advantages, benefits, comparisons and tips!  
Stacks of information all about this product are on page 171.

Gripping force (in power stroke) as a function of jaw length

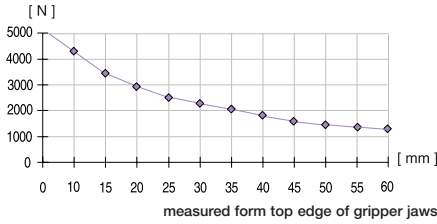

These wire thicknesses can be cut  
(35 mm from top edge of gripper)

- max. Ø 6,0 mm Copper wire
- max. Ø 5,0 mm Brass wire
- max. Ø 4,0 mm Steel wire (St52)

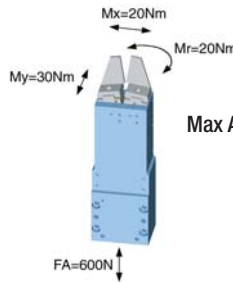

Max Allowable Forces on Jaws

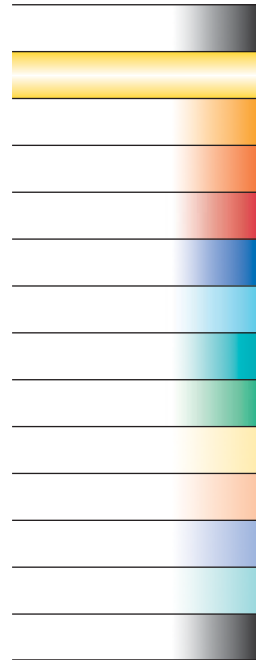

Order no.:	ZK33
Drive:	pneum.
Power stroke per jaw [°]:	9
Power Stroke per jaw [°]:	2
Gripping force in closing [N]:	4200
Gripping torque in closing [Nm]*:	110
Self-locking via:	mech.
Closing time/opening time [s]:	0,2
Repeatability± [mm]:	0,1
Min./max. operating pressure [bar]:	3/8
Air volume per cycle [cm³]:	73
Min./max. operating temperature [°C]:	5/80
Temp. resistant version up to 150° C [add to part number]:	T2
Piston diameter [mm]:	40
Weight [kg]:	1,3

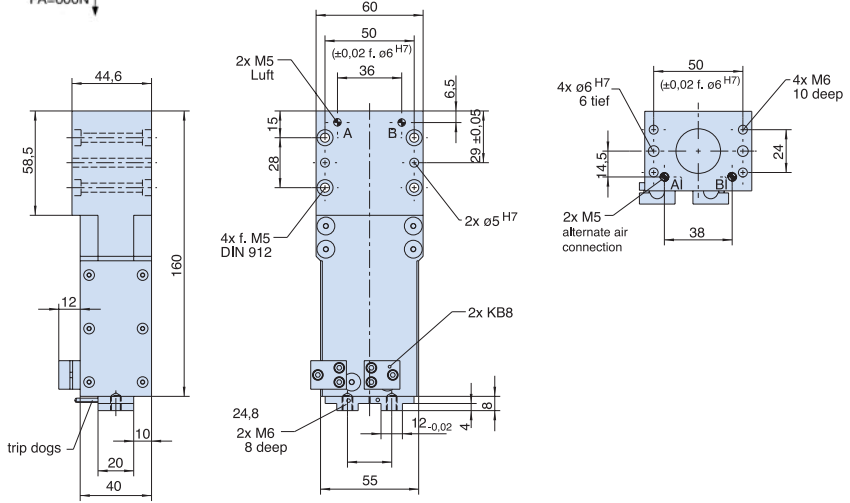

Order no.:	BK22	Knife 1	Knife 2	Knife 3	UB22
------------	------	---------	---------	---------	------

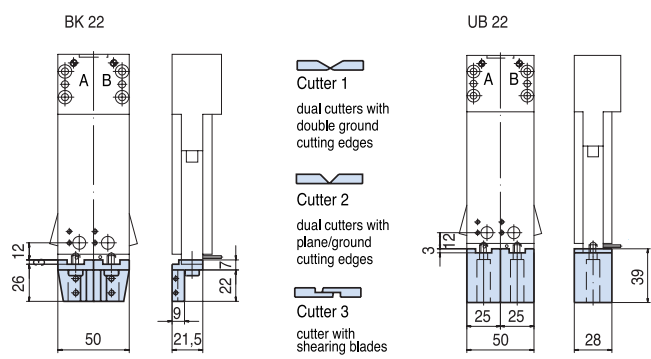

All data measured at 6 bar.  
All data measured at 10 mm from top edge of gripper jaw.  
\* measured at 1° opening angle/jaw.

See Page 171 for Accessory list.

Parallel gripper		Three-jaw gripper		Angle gripper		Internal-hole gripper		<b>Other grippers</b>		Electric gripper		
SCH20	SCH23	ST36	ST40	ZK22	ZK33	<b>GS65</b>	RGO-30	RG10-60	SPG30-95	GF40	GF41	HM

## 6-point gripper for O-ring assembly

Advantages, benefits, comparisons and tips!  
Stacks of information all about this product are  
on page 171.

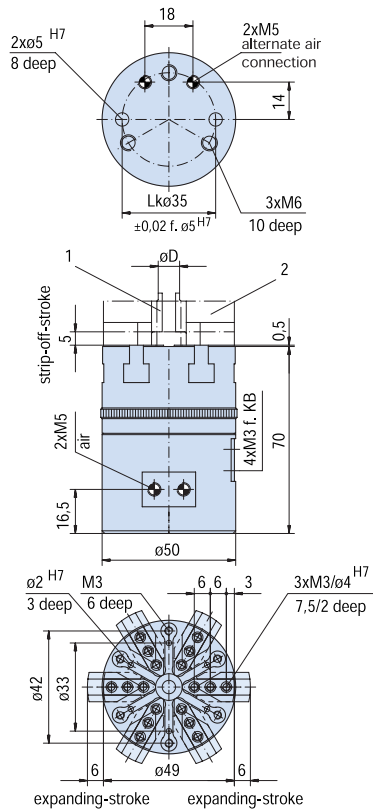
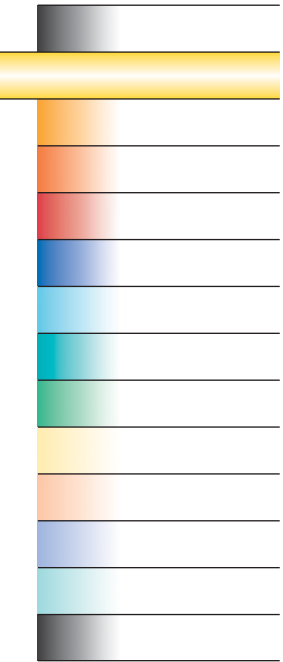

Order no.:				
<b>GS65</b>				
Drive:				
pneum.				
Opening stroke (adjustable for each jaw) [mm]:				
3-6				
Stripping stroke [mm]:				
5				
Gripping force in opening [N]:				
300				
Self-locking via:				
DSV1/8				
Closing time/opening time [s]:				
0,05				
Repeatability ± [mm]:				
0,1				
Min./max. operating pressure [bar]:				
4/8				
Air volume per cycle [cm <sup>3</sup> ]:				
7				
Min./max. operating temperature [°C]:				
5/80				
Temp. resistant version up to 150° C [add to part number]:				
T1				
Piston diameter [mm]:				
25				
Weight [kg]:				
0,55				

All data measured at 6 bar.

### Ejector Jaws Order no.: UB65-3

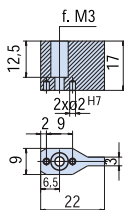

Ejector jaws  
(screws are included in the  
scope of delivery)  
order-no. UB 65-3

### Blank Jaws Order no.: UB65-2

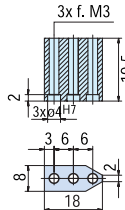

Non machined jaws  
for O-ring seal ø20-60 mm

### Opening/Expanding Jaws Order no.: UB65-1 (Aluminum) Order no.: UB65-4 (Steel)

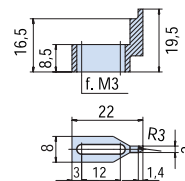

Jaws  
for O-ring seal ø4-20 mm

Parallel gripper		Three-jaw gripper		Angle gripper		Internal-hole gripper		Other grippers		Electric gripper		
SCH20	SCH23	ST36	ST40	ZK22	ZK33	GS65	RG0-30	RG10-60	SPG30-95	GF40	GF41	HM

# Tube gripper

Advantages, benefits, comparisons and tips!  
Stacks of information all about this product are on page 171.

Order no.:	
RG 0-30	RG 10-60
Drive:	
pneum.	pneum.
Grip diameter min./max. [mm]:	
0-28	10-58
Gripping force in closing [N]:	
350	1000
Self-locking via:	
DSV1/8	DSV1/8
Closing time/opening time [s]:	
0,3	0,3
Repeatability ± [mm]:	
0,1	0,1
Min./max. operating pressure [bar]:	
1/3	1/3
Air volume per cycle [cm <sup>3</sup> ]:	
5	33
Min./max. operating temperature [°C]:	
5/80	5/80
Temp. resistant version up to 150° C [add to part number]:	
TS	TS
Weight [kg]:	
0,278	0,845

All data measured at 3 bar.

## Tube Gripper (with diaphragm)

The tube gripper can hold a wide variety of shapes, whether round, oval or square (e.g. fluorescent tubes, incandescent bulbs, bottles, glasses or eggs). Even the most irregular parts can be gently and firmly gripped by adjusting the air pressure. The diaphragm conforms to any shape, producing a large gripping force that can even hold heavy parts.

Also available in high temperature model (up to 200° C) upon request.

CAUTION: Maximum pressure is 3 bar (43.5 psi).

Gripping force depends upon the diameter and surface area of the parts.

We therefore recommend the 10 day trial.

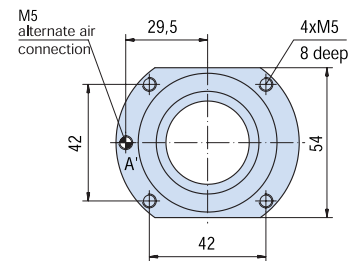
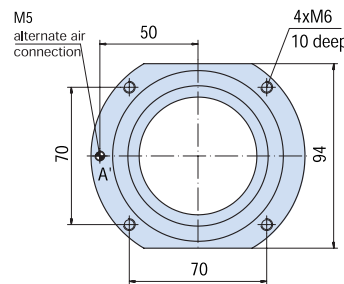
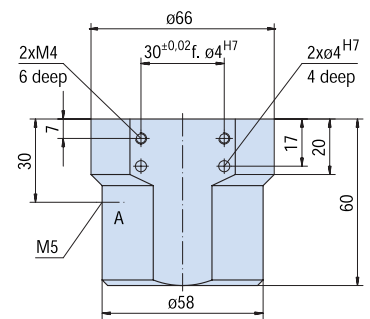
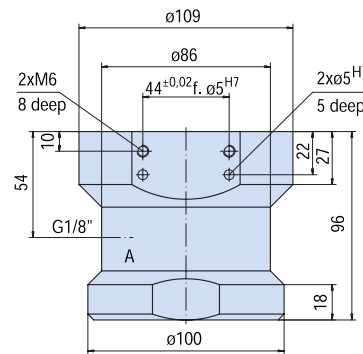
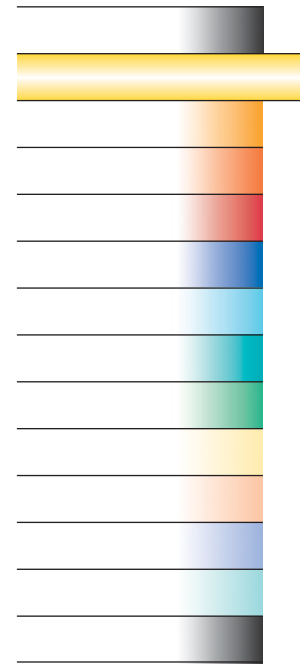

Parallel gripper		Three-jaw gripper		Angle gripper		Internal-hole gripper		Other grippers		Electric gripper		
SCH20	SCH23	ST36	ST40	ZK22	ZK33	GS65	RG0-30	RG10-60	<b>SPG30-95</b>	GF40	GF41	HM

## Rubber-finger gripper

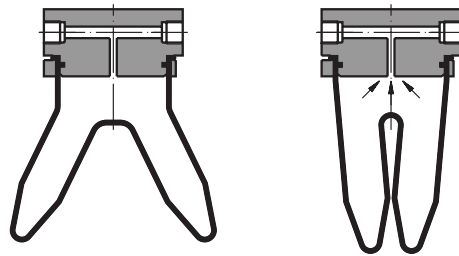
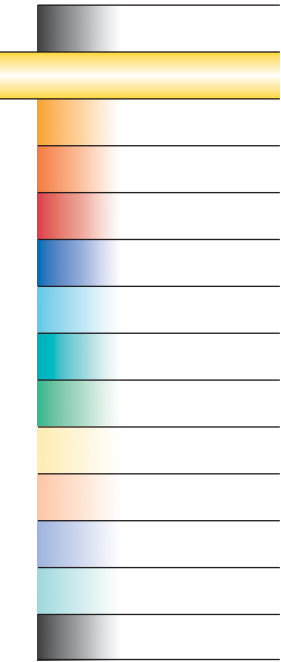

Advantages, benefits, comparisons and tips! Stacks of information all about this product are on page 171.

Order no.:				
<b>SPG 30-95</b>				
Drive:				
pneum.				
Grip diameter min. [mm]:				
30				
Grip diameter max. [mm]:				
95				
Gripping force in closing [N]:				
8				
Gripping force in opening [N]:				
2				
Self-locking via:				
in splitting				
Closing time/opening time [s]:				
0,2				
Repeatability ± [mm]:				
0,1				
Min./max. operating pressure [bar]:				
2/8				
Air volume per minute [cm <sup>3</sup> ]:				
3000				
Min./max. operating temperature [°C]:				
5/80				
Weight [kg]:				
0,28				

All data measured at 4 bar.

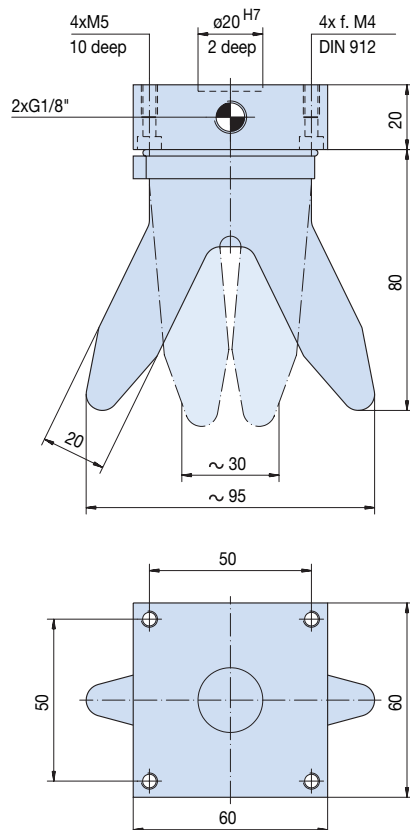

Parallel gripper		Three-jaw gripper		Angle gripper		Internal-hole gripper		Other grippers			Electric gripper	
SCH20	SCH23	ST36	ST40	ZK22	ZK33	GS65	RG0-30	RG10-60	SPG30-95	<b>GF40</b>	<b>GF41</b>	HM

# Rubber-finger gripper

Advantages, benefits, comparisons and tips!  
Stacks of information all about this product are on page 171.

Order no.:	
GF 40	GF 41
Drive:	
pneum.	-
Grip diameter min./max. [mm]:	
40 -164	-
Gripping force in closing [N]:	
25	-
Self-locking via:	
DSV1/8	-
Closing time/opening time [s]:	
0,6	-
Min./max. operating pressure [bar]:	
1/2	-
Air volume per cycle [cm³]:	
17	-
Min./max. operating temperature [°C]:	
5/80	-
Weight [kg]:	
0,410	0,355

All data measured at 2 bar.

See Page 171 for Accessory list.

## Rubber-Finger Gripper (for sensitive parts)

This rubber-finger gripper handles round, oval and even odd-shaped parts very gently and securely. With an applied air pressure of up to 2 bar, the rubber gripper bends and completely surrounds the workpiece. The knobbed surface provides secure gripping for loads in all directions. The gripping force can be adjusted by varying the applied pressure. When the air pressure is removed, the gripper springs back to its original position.

The optional GF41 mounting fixture allows the distance between the fingers to be adjusted to suit the particular workpiece.

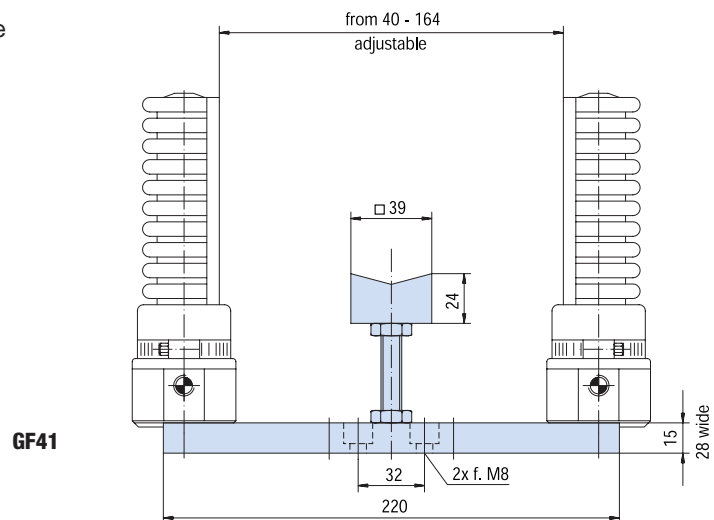
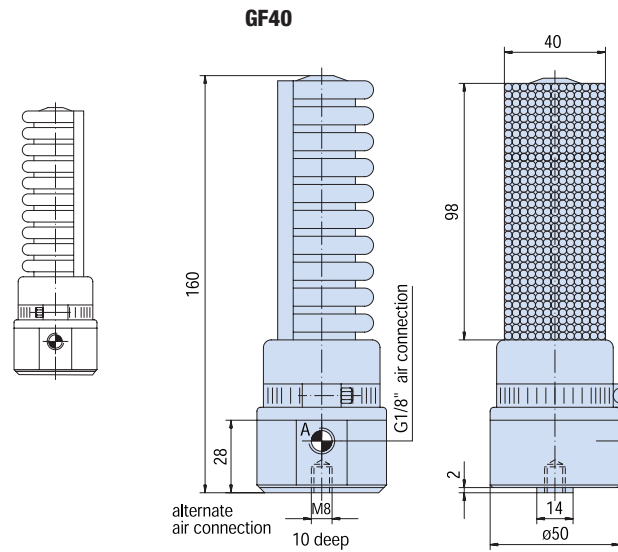
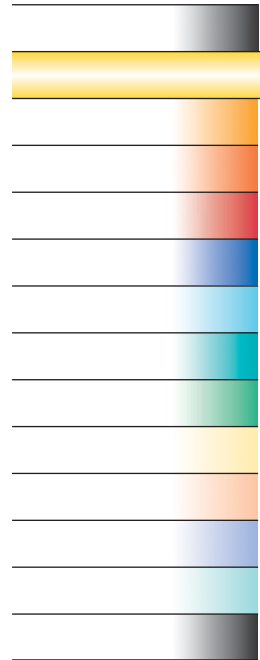



## Magnetic gripper



Advantages, benefits, comparisons and tips!  
Stacks of information all about this product are on page 171.

Order no.:					
HM31	HM34	HM43	HM54		
<b>Retention force [N]:</b>					
15	30	60	100		
<b>Output [W]:</b>					
6	6	8	10		
<b>Dimension A [mm]:</b>					
11,0	13,0	19,0	26,0		
<b>Dimension B [mm]:</b>					
39,0	45,0	54,0	65,0		
<b>Dimension C [mm]:</b>					
14,5	17,0	20,3	21,5		
<b>Dimension Ø [mm]:</b>					
33,5	38,0	47,0	58,0		
<b>Dimension E [mm]:</b>					
1,5	2,0	2,0	2,0		
<b>Dimension F [mm]:</b>					
28,0	31,0	40,0	50,0		
<b>Weight [kg]:</b>					
0,054	0,083	0,140	0,220		

See Page 171 for Accessory list.

### The Magnetic Gripper

A unique feature which sets the magnetic gripper apart from other grippers is that it leaves little to no residual magnetic charge when turned off, therefore releasing the part instantly.

The magnetic gripper is able to release its load quickly, and despite its compact size, can sustain enormous holding power. Its lightweight design will ultimately reduce wear on your automatic equipment. The magnetic gripper is available in four sizes, to accommodate virtually any size load. You will be amazed by what it can hold!

**Ideal for handling sheet metal parts.**

