

# Metal bellows couplings

## Series DK/S – miniature

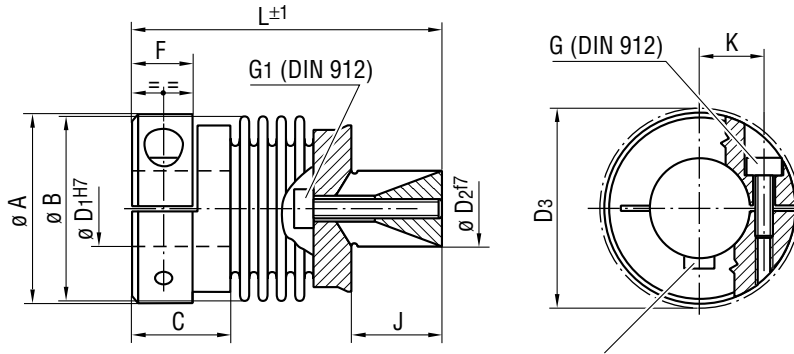

Keyway according to DIN 6885<sup>1)</sup> on demand

### Technical Data, Dimensions

TYPE	DIMENSIONS (mm)												TECHNICAL DATA					
	Ø A	Ø B	C	L (±1)	F	D <sub>1</sub> (H7) from/to	D <sub>2</sub> (f7)	J	D <sub>3</sub> Clear- ance dia- meter	G (DIN 912)	K	G <sub>1</sub> (DIN 912)	Nominal- torque  T <sub>KN</sub> (Nm)	Misalignment (mm)		Torsio- nal stiffness  C <sub>T dyn</sub> (Nm/rad)	Moment of inertia J (g cm <sup>2</sup> )	Weight  m (g)
														radial ΔK <sub>r</sub>	axial ΔK <sub>a</sub>			
DK/S 4/29	15.5	15	9	29	5.7	3-6.5	8	8	17.5	M2	5.6	M3	0.4	0.1	0.2	254	3.0	10.9
DK/S 4/31	15.5	15	9	31	5.7	3-6.5	8	8	17.5	M2	5.6	M3	0.4	0.15	0.3	190	3.0	11.3
DK/S 4/35	15.5	15	9	35	5.7	3-6.5	8	8	17.5	M2	5.6	M3	0.4	0.2	0.4	152	3.0	11.4
DK/S 9/30	15.5	15	9	30	5.7	3-6.5	8	8	17.5	M2	5.6	M3	0.9	0.1	0.2	507	3.0	11.8
DK/S 9/33	15.5	15	9	33	5.7	3-6.5	8	8	17.5	M2	5.6	M3	0.9	0.15	0.3	380	3.0	12.7
DK/S 9/37	15.5	15	9	37	5.7	3-6.5	8	8	17.5	M2	5.6	M3	0.9	0.2	0.4	305	3.0	12.9
DK/S 15/37	20	19	12	37	7	3-10	10	12	21	M2.5	7	M4	1.5	0.1	0.25	748	11	23.6
DK/S 15/41	20	19	12	41	7	3-10	10	12	21	M2.5	7	M4	1.5	0.15	0.4	701	12	25.0
DK/S 20/41	25	24	13	41	8	3-12	10	12	27	M3	9	M4	2.0	0.1	0.3	1530	21	37.8
DK/S 20/47	25	24	13	47	8	3-12	10	12	27	M3	9	M4	2.0	0.2	0.4	1290	23	41.4
DK/S 20/51	25	24	13	51	8	3-12	10	12	27	M3	9	M4	2.0	0.25	0.5	1030	25	41.7
DK/S 45/52	32	32	16	52	10	6-16	14	16	34	M4	11.5	M5	4.5	0.1	0.3	6450	80	83.4
DK/S 45/61	32	32	16	61	10	6-16	14	16	34	M4	11.5	M5	4.5	0.2	0.5	4030	86	89.6
DK/S 100/61	40	40	16	61	10	6-19	16	20	41.5	M4	15.5	M6	10	0.15	0.4	8070	224	129.8
DK/S 100/71	40	40	16	71	10	6-19	16	20	41.5	M4	15.5	M6	10	0.25	0.5	6720	256	146.7

### Angular misalignment:

1.2° to 2°, depending on length

### Hub bores:

D<sub>2</sub>: We recommend an H8 fitting for the shaft bore.

### Standard bores:

DK/S 4-15      D<sub>1</sub> = 6H7  
 DK/S 20        D<sub>1</sub> = 6H7 und 10H7  
 DK/S 45-100   D<sub>1</sub> = 10H7

### Tooling materials:

Hubs made of anodized aluminum, DK/S 4-9 expanding hubs made of brass, DK/15-100 expanding hubs made of steel, metal bellows made of stainless steel.  
 Stainless steel version also available.

1) Tolerance of keyway: Standard JS9