

Metal bellows couplings

Series AKD with collet clamp

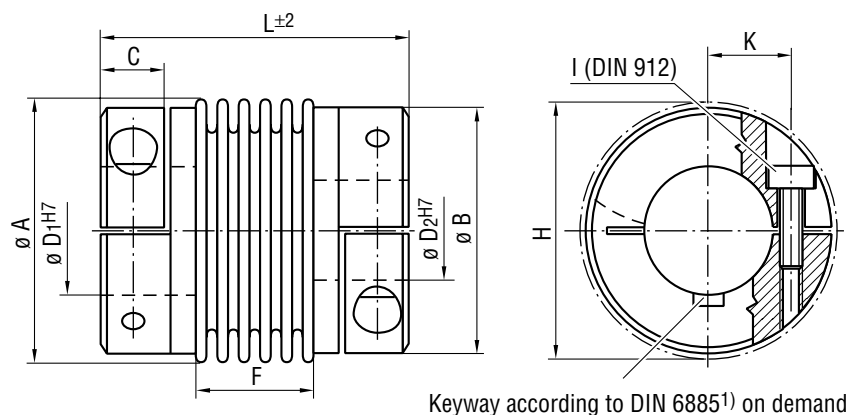

Technical Data – Series AKD

| TYPE | 18 | 30 | 60 | 80 | 150 | 200 | 300 | 500 |
|---|-------|----------|---------|-------------|-------------|---------|---------|------|
| Nominal moment (Nm) T_{KN} | 18 | 30 | 60 | 80 | 150 | 200 | 300 | 500 |
| Torsional stiffness (10^3 Nm/rad) C_T dyn | 6 | 26 | 49 | 74 | 101 | 116 | 280 | 310 |
| Radial spring (N/mm) C_r | 86 | 222 | 333 | 403 | 601 | 450 | 1470 | 972 |
| Axial spring (N/mm) C_a | 39 | 27 | 53 | 53 | 86 | 85 | 153 | 86 |
| Moment of inertia (10^{-3} Kg m^2) J | 0.08 | 0.1/0.16 | 0.3/0.5 | 1.4/2.3/2.8 | 1.4/2.3/2.8 | 2.6/4.2 | 4.6/6.2 | 9 |
| Tightening torque of retaining screws (Nm) M_A | 6/6 | 15/12 | 40/30 | 60/55/50 | 80/70/50 | 100/80 | 110/90 | 145 |
| Weight (ca. kg) m | 0.2 | 0.2/0.3 | 0.5/0.6 | 1.7/2.1/2.3 | 1.7/2.1/2.3 | 2.5/3.3 | 3.4/4.1 | 4.9 |
| Max. approved misalignment | | | | | | | | |
| - radial (mm) ΔK_r | 0.2 | 0.2 | 0.2 | 0.2 | 0.2 | 0.2 | 0.2 | 0.2 |
| - axial (mm) ΔK_a | 0.5 | 0.5 | 0.5 | 0.5 | 0.5 | 0.5 | 0.5 | 1 |
| - angular (degree) ΔK_w | 1.5 | 1.5 | 1.5 | 1.5 | 1.5 | 1.5 | 1.5 | 1.5 |
| Max. rotating speed at $V = 30$ m/s (rpm) n_{max} | 12700 | 10200 | 8600 | 6800 | 6800 | 6300 | 5900 | 4900 |

Dimensions (mm) – Series AKD

| TYPE | 18 | 30 | 60 | 80 | 150 | 200 | 300 | 500 |
|--|-------|-------|-------|----------|----------|-------|-------|------|
| $L_{\pm 2}$ | 71 | 73 | 89 | 103 | 104 | 113 | 115 | 122 |
| $\varnothing A$ | 45 | 56 | 66 | 82 | 82 | 90 | 110 | 112 |
| $\varnothing B$ | 45 | 47/56 | 57/66 | 68/80/84 | 68/80/84 | 80/90 | 90/96 | 110 |
| C | 12 | 15 | 19.5 | 21.5 | 21.5 | 25.5 | 28 | 29.5 |
| $\varnothing D_1^{H7} / \varnothing D_2^{H7}$ 2) | | | | | | | | |
| - min. | 10/20 | 10/20 | 14/23 | 20/28/35 | 20/28/35 | 25/32 | 32/40 | 40 |
| - max. | 20/25 | 20/25 | 23/35 | 28/35/40 | 28/35/40 | 32/42 | 40/45 | 60 |
| F | 32 | 24 | 31 | 35 | 36 | 37 | 40 | 40 |
| I | M5 | M6 | M8 | M10 | M10 | M12 | M12 | M12 |
| K | 17.5 | 16/20 | 20/24 | 24/27/28 | 24/27/28 | 26/31 | 32/35 | 40 |
| H (parasitic disturbance) | 48 | 56 | 70 | 84 | 84 | 93 | 102 | 108 |

Hubs 18 to 60 made of aluminum,
Hubs 80 to 500 made of steel, other
materials available on request.

1) Tolerance of keyway: Standard JS9.

2) Smaller \varnothing possible for lower torque of
transmission.

3) Stainless steel version also available.